

## FH-TSB-004 Fence Hog® Tilt Attachment Retrofit

Included Parts	
QTY	Description
2	Stiffening Angles
1	Upper Tilt Cylinder Mount
1	Tilt Cylinder
1	Selector Valve
1	Tilt Attachment
6	1/2"x2" Bolt
10	1/2"x1-1/2" Bolt
2	3/4"x5" GR8 Bolt
2	Lock Nut
4	1/2"x3-1/2" Bolt
20	1/2" lock Nut
1	Optional Valve Mount 1
1	Optional Valve Mount 2

### Required Tools:

7/16", 3/4", 7/8", 1-1/16", and 1-1/8" Combination Wrench

7/16", 9/16", and 3/4" Sockets with Ratchet Driver

9/16" Drill Bit and Drill

Black Marker

### Directions:

- 1) Note which holes the existing Attachment Plate uses and remove it from the Fence Hog®. The existing Attachment Plate and hardware will not be reinstalled.
- 2) Mark and Drill (4) 9/16" holes in the Bottom Attachment Plate Mount as shown in drawing FH-24-14.
- 3) Remove the Hydraulic Hoses from the Right Cylinder.
- 4) Remove the Hydraulic Hoses for the Left Cylinder from the existing Relief Valve.
- 5) If the Fence Hog® is fitted with an Extension, disconnect the Hydraulic Hoses going to the Extension.
- 6) Remove the existing Relief Valve. The existing Relief Valve, Hydraulic hoses for the Right Cylinder, and Supply Hydraulic Hoses will not be reinstalled.
- 7) If the Fence Hog® is fitted with an Extension mark the fittings on each Pigtail with its corresponding Port. Remove the Pigtails from the top of the Relief Valve. The Pigtails will be reused.
- 8) If the Fence Hog® is fitted with an Extension install the existing Pigtails into the supplied Selector Valve. Install the appropriately marked Pigtail into the corresponding Port. The supplied Hydraulics Drawing also shows the Pigtail Locations.
- 9) If the Tilt Cylinder is installed on Tilt Attachment, remove the Tilt Cylinder from Top and Bottom Mounts.
- 10) Install the supplied Tilt Attachment as shown in supplied Drawing. Note the Stiffening Angles need to be installed with the top set of Tilt Attachment holes.
- 11) Install the Upper Tilt Cylinder Mount. The Mount slides over the Cross Bar and is held tight vertically with the Set Bolt. The Upper Mount Backing Plate holds the Mount horizontally.
- 12) Install the Selector Valve.

**Note: On Fence Hog's Built Before Serial Number 03125 an Optional Valve Mount may be required. Two Valve Mounts have been supplied with the Tilt Attachment. Depending on Model and Build date either of these mounts may be needed.**

- 13) Install the Tilt Cylinder
- 14) Install the exiting Left Cylinder Hoses into the Selector Valve. Reference included Hydraulic drawing for Hose Routing.
- 15) Install the supplied Right Cylinder Hose into the Right Cylinder.
- 16) Route the Supply Hydraulic Hoses and Control Pendant between the Fence Hog® and the Tilt Cylinder.

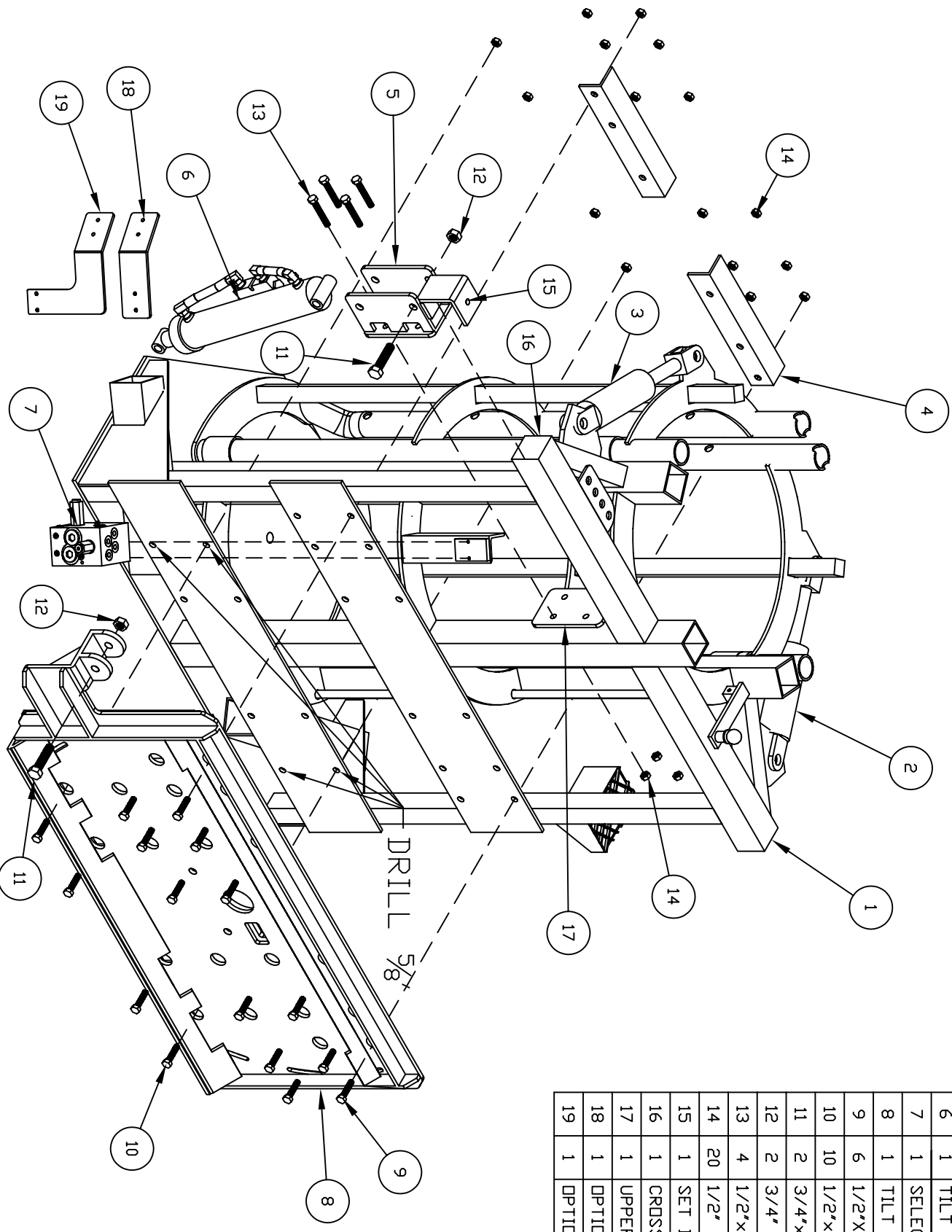

ITEM	QTY	DESCRIPTION
1	1	FENCE HOG (EXISTING)
2	1	RIGHT CYLINDER (EXISTING)
3	1	LEFT CYLINDER (EXISTING)
4	2	STIFFENING ANGLES
5	1	UPPER TILT CYLINDER MOUNT
6	1	TILT CYLINDER
7	1	SELECTOR VALVE
8	1	TILT ATTACHMENT
9	6	1/2"x2" BOLT
10	10	1/2"x1-3/4" BOLT
11	2	3/4"x5" GR8 BOLT
12	2	3/4" LOCK NUT
13	4	1/2"x3-1/2" BOLT
14	20	1/2" LOCK NUT
15	1	SET BOLT
16	1	CROSS BAR (EXISTING)
17	1	UPPER MOUNT BACKING PLATE
18	1	OPTIONAL VALVE MOUNT 1
19	1	OPTIONAL VALVE MOUNT 2

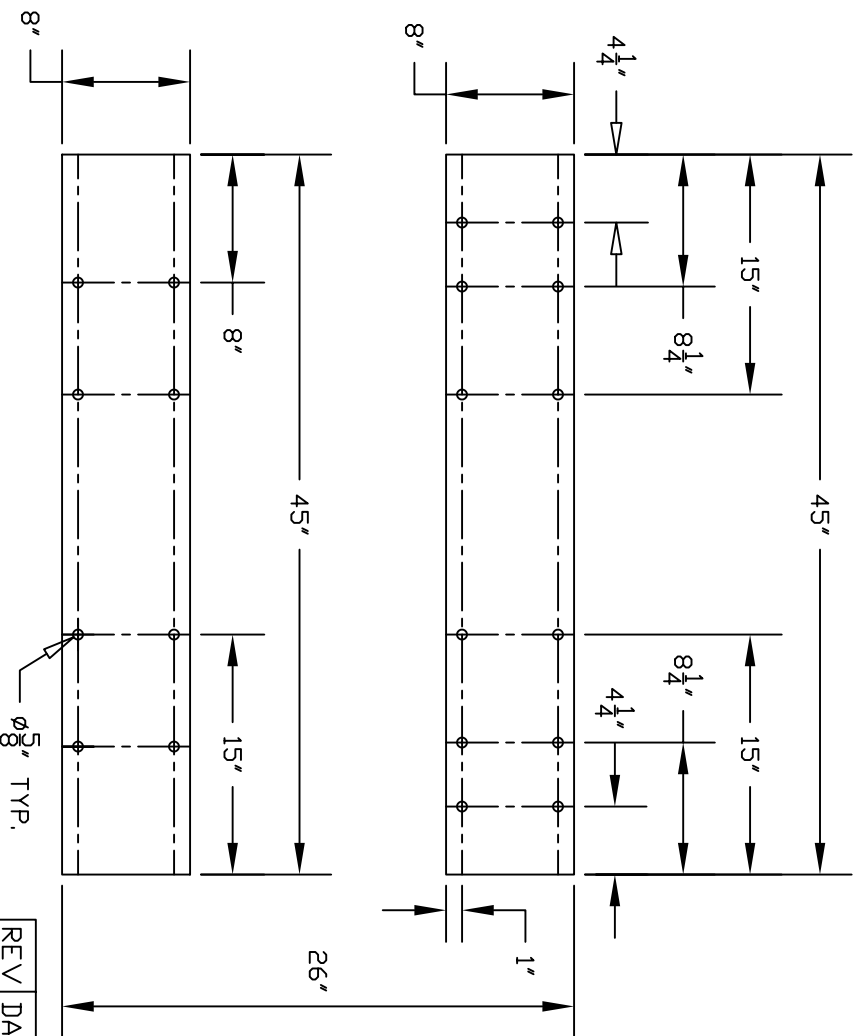

REV	DATE	DESCRIPTION	DWG	CKD
A	10/21/03	ADDED HOLES TO BOTTOM PLATE	SRL	

24" FENCE HOG  
MOUNTS FOR ATTACHMENT PLATE

EZ-GROUT, CORP,  
5950 S. E. RT, 60  
MCCONNELSVILLE, OH 43756

DWG BY: Scott R. Lang  
DWG NO.: FH-24-14  
SCALE: 1"=12"

CHECKED BY:  
DWG DATE: 03/18/02  
CHECK DATE:

SHEET NUMBER OF  
REV. A

ALL DRAWINGS ARE THE  
PROPERTY OF EZ-GROUT,  
CORP., MCCONNELSVILLE,  
OHIO. COPYING OR CHANGING  
WITHOUT THE WRITTEN  
CONSENT OF THE  
OWNER IS PROHIBITED.

